

TEXS160-E1.5

Available Tip Styles:

Available Receptacle:

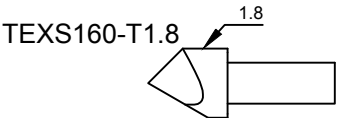
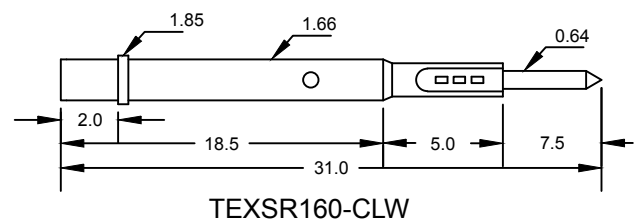
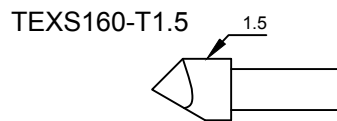
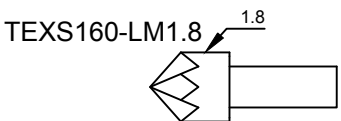
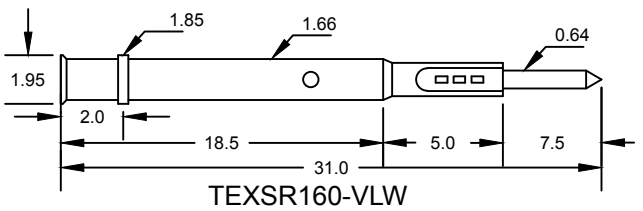
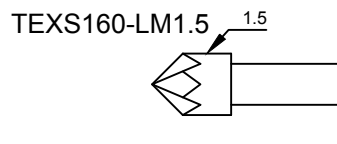
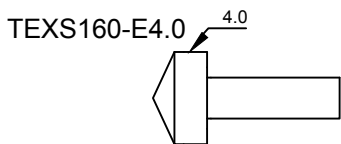
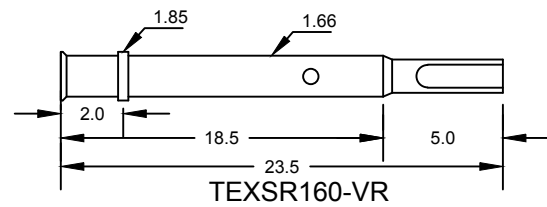
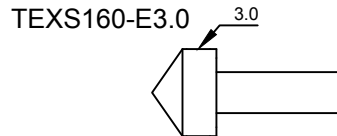
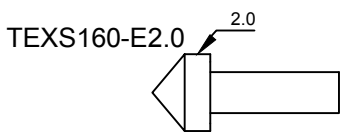
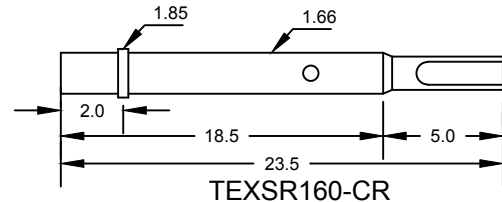
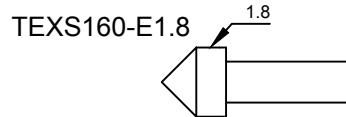
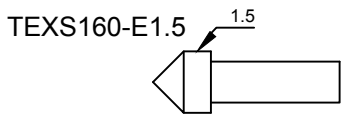

■ Mechanical

Pitch: 2.54mm

Recommended travel: 2.0mm

Full travel: 3.0mm

Spring force: 200g±5% at recommended travel

■ Material and plating

Plunger: BeCu, Gold plated

Barrel: Bronze, Gold plated

Spring: Music Wire Gold plated

Receptacle: Bars, Gold plated

■ Electrical Specifications

Current Rating: 3amps

Resistance: Less than 50mΩ

■ Receptacle Specifications

Mounting Hole Size: 1.75-1.80mm

	Name	Date	Description:	Scale:	
Drawn					
Approved					
Checked					
			Part NO:	TEXS160-Series	Index: Size: A4